

變更高雄市湖內（大湖地區）主要計畫 （第三次通盤檢討暨都市計畫圖重製）（第二階段）案樁位圖1

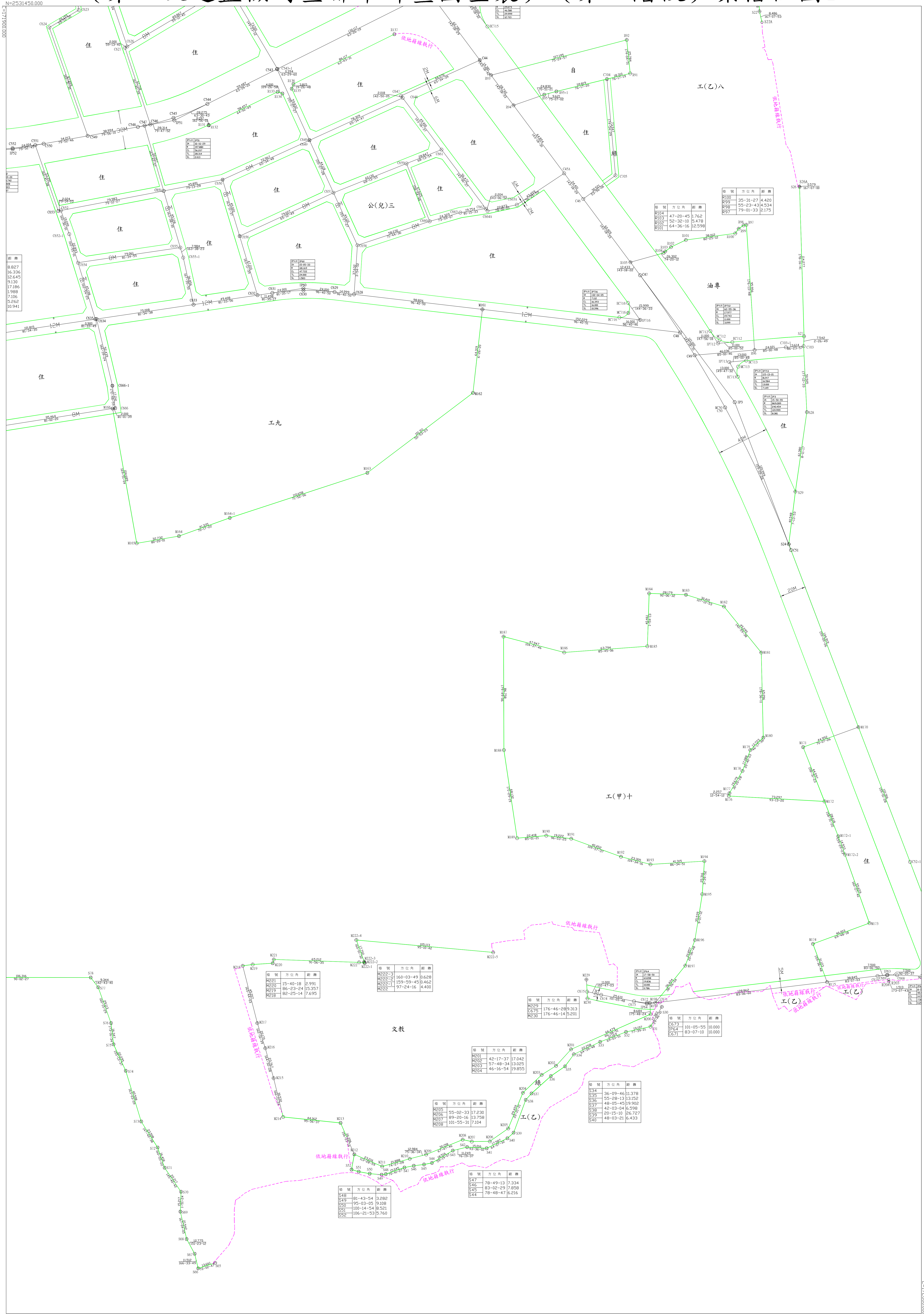

比例尺1:1000

N=2530450.000

變更高雄市湖內（大湖地區）主要計畫 （第三次通盤檢討暨都市計畫圖重製）（第二階段）案樁位圖2

N=2533750.000
E=1712003.000

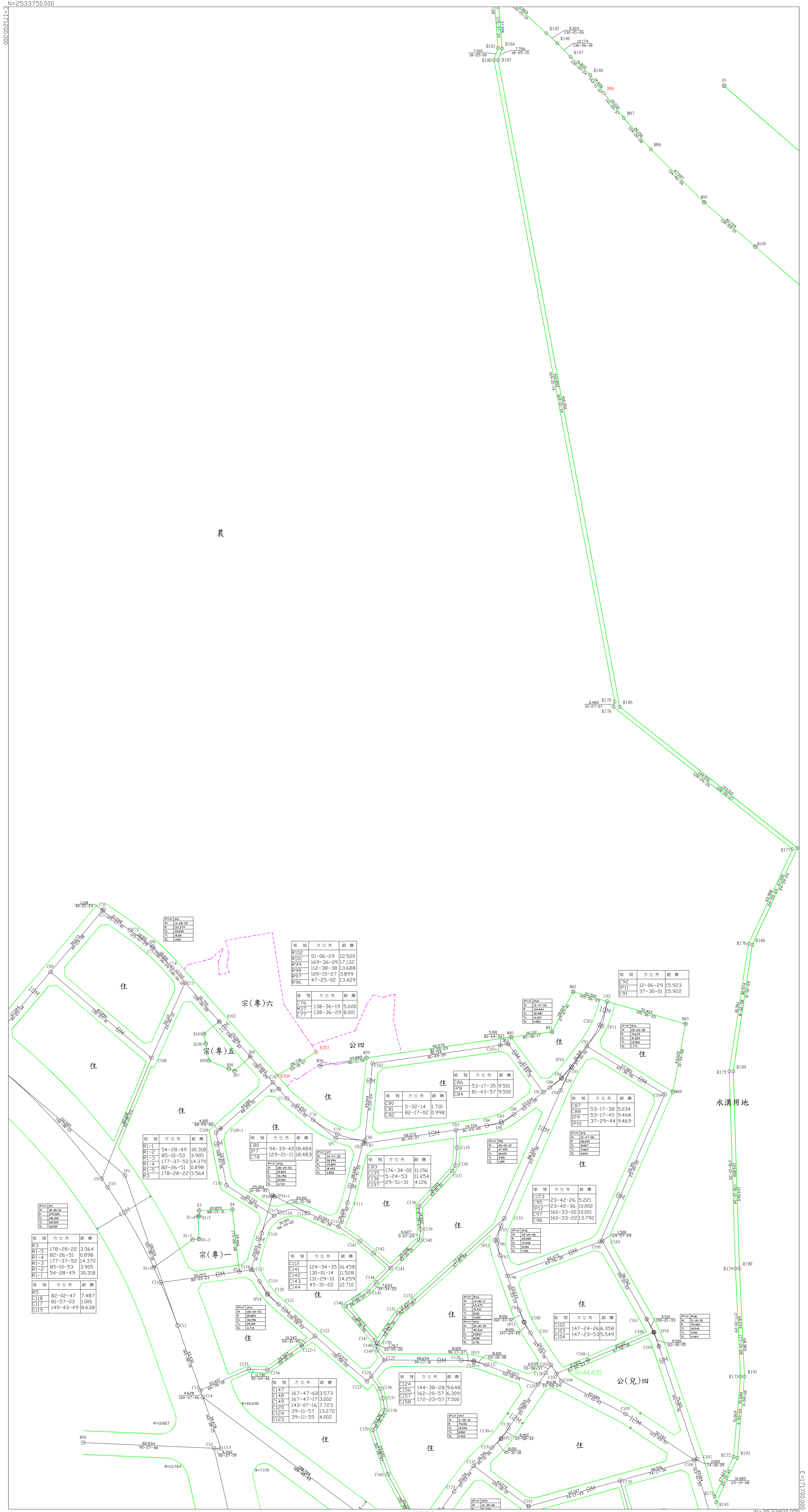

表

樁號	方位角	距離
R3	178-28-22	3.564
R1-5	82-26-51	0.898
R1-4	177-37-52	14.370
R1-3	85-10-53	3.905
R1-2	54-28-49	30.318
R1-1	54-28-49	30.318
R5	82-02-47	7.487
C118	81-57-03	1.000
C119	149-43-49	8.638
R102	51-06-29	12.520
R101	169-36-09	17.132
R99	112-38-38	13.688
R98	109-15-27	3.899
R96	47-25-02	13.429
C76	138-36-19	5.600
C37	138-36-29	8.001
C77	138-36-29	8.001
C102	51-06-29	12.520
C101	169-36-09	17.132
C99	112-38-38	13.688
C98	109-15-27	3.899
C96	47-25-02	13.429
C109-1	54-28-49	30.318
C80	94-33-42	18.484
IP7	129-21-11	18.483
C78	94-33-42	18.484
C112	124-34-35	16.458
C141	130-01-14	11.528
C142	131-29-10	14.259
C143	45-31-22	12.710
C144	45-31-22	12.710
C147	167-47-60	3.573
C148	167-47-17	3.002
C149	143-07-16	7.723
C125	39-11-57	13.272
C124	39-11-57	13.272
C123	39-11-55	4.002
C124	144-38-28	9.648
C156	162-20-57	6.309
C157	172-23-57	7.500
C158	172-23-57	7.500
C159	172-23-57	7.500
C160	172-23-57	7.500
C161	172-23-57	7.500
C162	172-23-57	7.500
C163	172-23-57	7.500
C164	172-23-57	7.500
C165	172-23-57	7.500
C166	172-23-57	7.500
C167	172-23-57	7.500
C168	172-23-57	7.500
C169	172-23-57	7.500
C170	172-23-57	7.500
C171	172-23-57	7.500
C172	172-23-57	7.500
C173	172-23-57	7.500
C174	172-23-57	7.500
C175	172-23-57	7.500
C176	172-23-57	7.500
C177	172-23-57	7.500
C178	172-23-57	7.500
C179	172-23-57	7.500
C180	172-23-57	7.500
C181	172-23-57	7.500
C182	172-23-57	7.500
C183	172-23-57	7.500
C184	172-23-57	7.500
C185	172-23-57	7.500
C186	172-23-57	7.500
C187	172-23-57	7.500
C188	172-23-57	7.500
C189	172-23-57	7.500
C190	172-23-57	7.500
C191	172-23-57	7.500
C192	172-23-57	7.500
C193	172-23-57	7.500
C194	172-23-57	7.500
C195	172-23-57	7.500
C196	172-23-57	7.500
C197	172-23-57	7.500
C198	172-23-57	7.500
C199	172-23-57	7.500
C200	172-23-57	7.500
C92	12-06-29	15.923
IP11	37-30-01	15.922
C91	37-30-01	15.922
C87	53-17-38	5.034
C88	53-17-45	9.468
IP9	37-29-44	9.469
IP10	37-29-44	9.469
C153	23-42-26	5.221
C95	23-42-36	10.002
IP12	160-33-02	10.001
C97	160-33-02	10.001
C98	160-33-22	13.792
C102	147-24-26	6.358
C103	147-23-53	5.549
C104	147-23-53	5.549
C105	147-23-53	5.549
C106	147-23-53	5.549
C107	147-23-53	5.549
C108	147-23-53	5.549
C109	147-23-53	5.549
C110	147-23-53	5.549
C111	147-23-53	5.549
C112	147-23-53	5.549
C113	147-23-53	5.549
C114	147-23-53	5.549
C115	147-23-53	5.549
C116	147-23-53	5.549
C117	147-23-53	5.549
C118	147-23-53	5.549
C119	147-23-53	5.549
C120	147-23-53	5.549
C121	147-23-53	5.549
C122	147-23-53	5.549
C123	147-23-53	5.549
C124	147-23-53	5.549
C125	147-23-53	5.549
C126	147-23-53	5.549
C127	147-23-53	5.549
C128	147-23-53	5.549
C129	147-23-53	5.549
C130	147-23-53	5.549
C131	147-23-53	5.549
C132	147-23-53	5.549
C133	147-23-53	5.549
C134	147-23-53	5.549
C135	147-23-53	5.549
C136	147-23-53	5.549
C137	147-23-53	5.549
C138	147-23-53	5.549
C139	147-23-53	5.549
C140	147-23-53	5.549
C141	147-23-53	5.549
C142	147-23-53	5.549
C143	147-23-53	5.549
C144	147-23-53	5.549
C145	147-23-53	5.549
C146	147-23-53	5.549
C147	147-23-53	5.549
C148	147-23-53	5.549
C149	147-23-53	5.549
C150	147-23-53	5.549
C151	147-23-53	5.549
C152	147-23-53	5.549
C153	147-23-53	5.549
C154	147-23-53	5.549
C155	147-23-53	5.549
C156	147-23-53	5.549
C157	147-23-53	5.549
C158	147-23-53	5.549
C159	147-23-53	5.549
C160	147-23-53	5.549
C161	147-23-53	5.549
C162	147-23-53	5.549
C163	147-23-53	5.549
C164	147-23-53	5.549
C165	147-23-53	5.549
C166	147-23-53	5.549
C167	147-23-53	5.549
C168	147-23-53	5.549
C169	147-23-53	5.549
C170	147-23-53	5.549
C171	147-23-53	5.549
C172	147-23-53	5.549
C173	147-23-53	5.549
C174	147-23-53	5.549
C175	147-23-53	5.549
C176	147-23-53	5.549
C177	147-23-53	5.549
C178	147-23-53	5.549
C179	147-23-53	5.549
C180	147-23-53	5.549
C181	147-23-53	5.549
C182	147-23-53	5.549
C183	147-23-53	5.549
C184	147-23-53	5.549
C185	147-23-53	5.549
C186	147-23-53	5.549
C187	147-23-53	5.549
C188	147-23-53	5.549
C189	147-23-53	5.549
C190	147-23-53	5.549
C191	147-23-53	5.549
C192	147-23-53	5.549
C193	147-23-53	5.549
C194	147-23-53	5.549
C195	147-23-53	5.549
C196	147-23-53	5.549
C197	147-23-53	5.549
C198	147-23-53	5.549
C199	147-23-53	5.549
C200	147-23-53	5.549

N=2532800.000
E=1712003.000

變更高雄市湖內（大湖地區）主要計畫
（第三次通盤檢討暨都市計畫圖重製）（第二階段）案樁位圖3

N=-137750.000
E=-45750.000

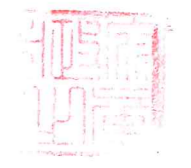
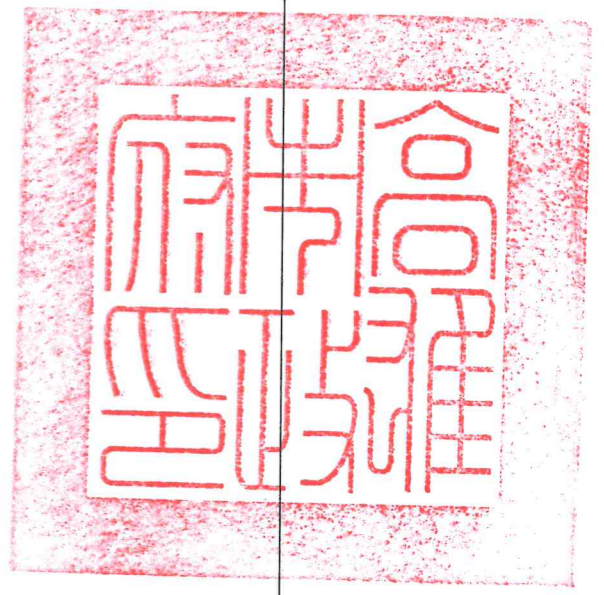
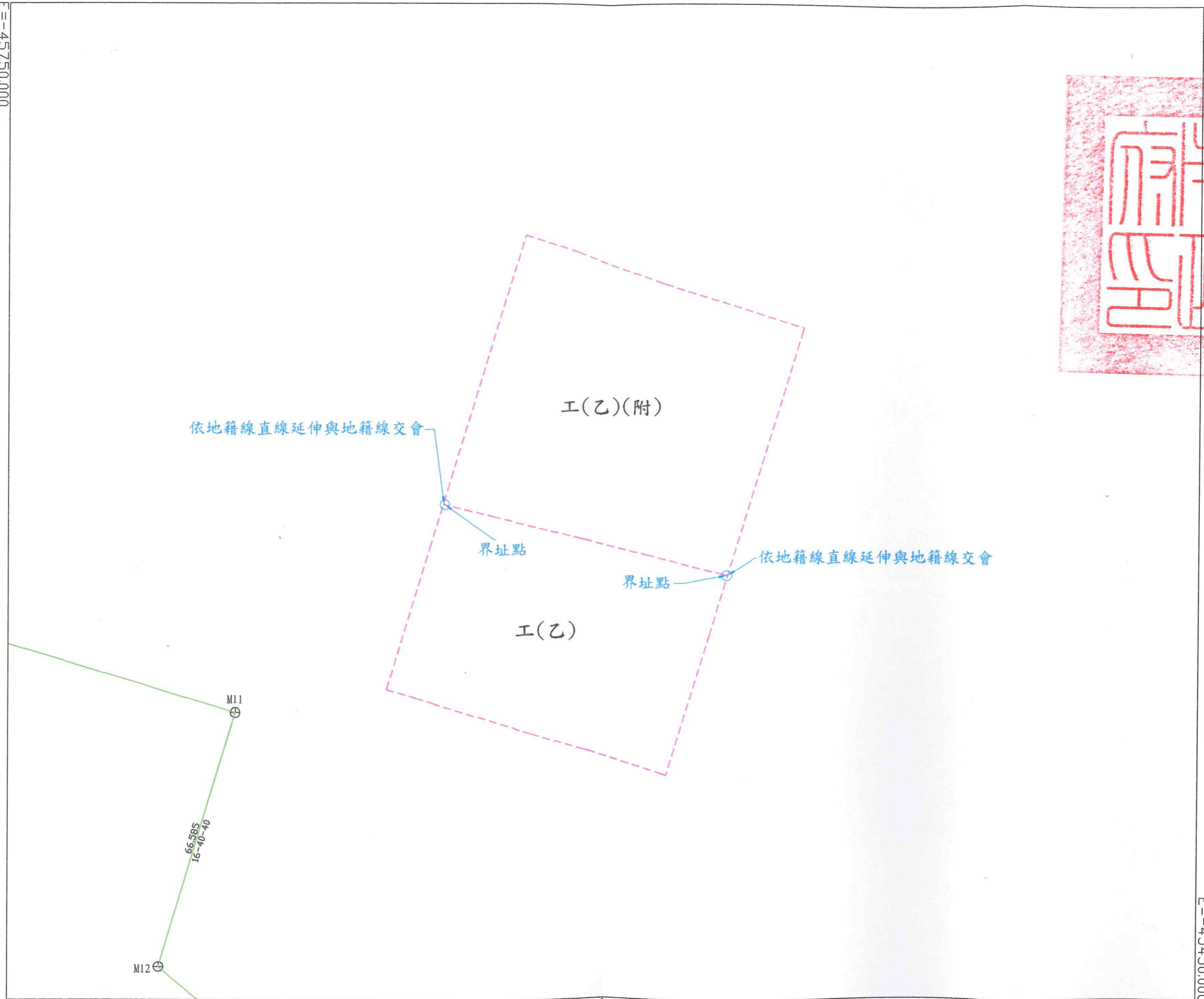

比例尺1:1000

E=-45450.000
N=-138000.000