

變更高雄市大坪頂以東地區都市計畫 (配合鳳鼻頭(中坑門)國定遺址保存及苦苓腳自辦市地重劃區計畫道路調整)案樁位圖

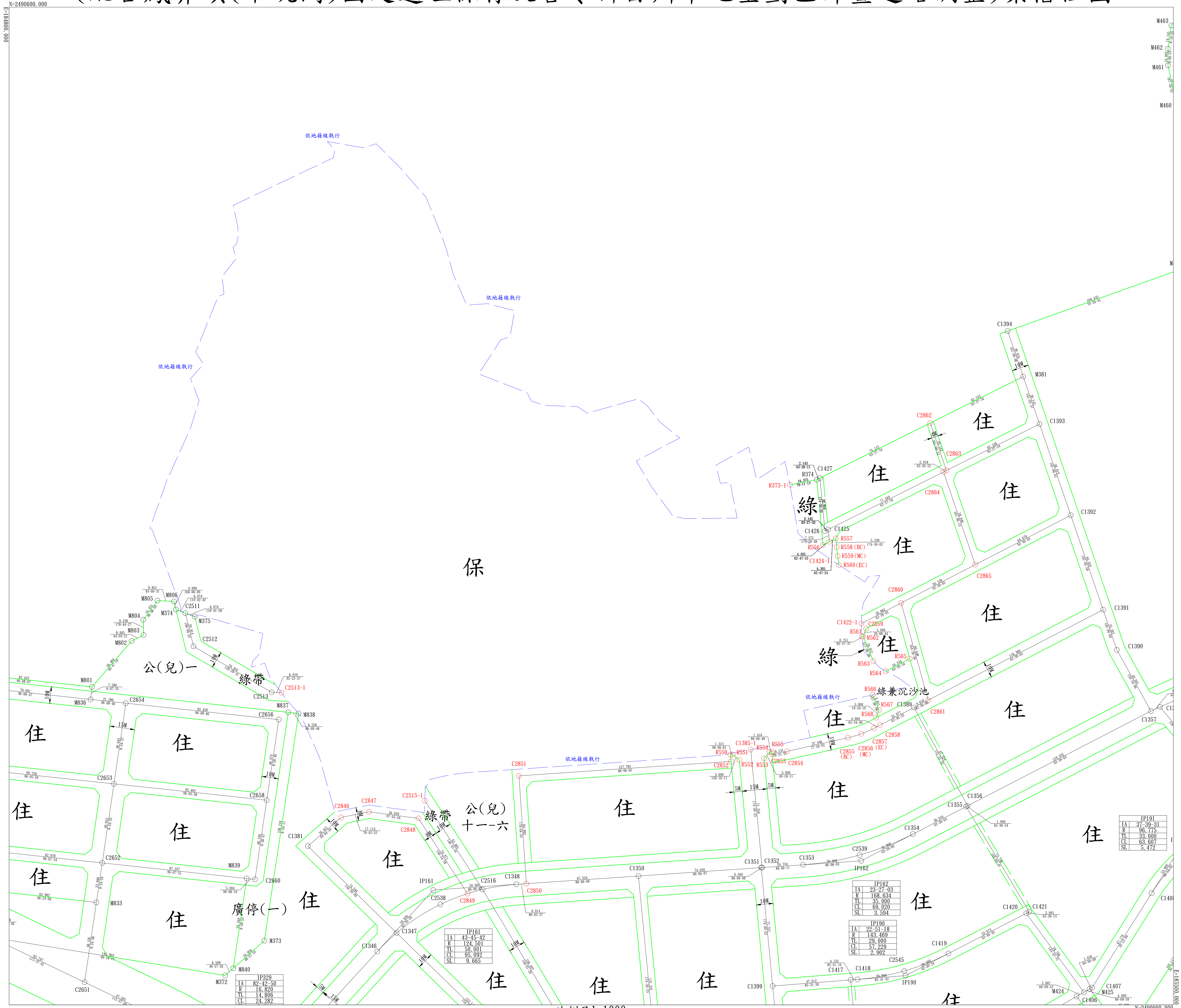

比例尺 1:1000

IP329	
IA	82.42.50
R	16.820
TL	14.806
CL	24.282

IP161	
IA	43.46.42
R	124.501
TL	50.001
CL	95.092
SL	9.665

IP162	
IA	23.27.03
R	168.634
TL	35.000
CL	57.229
SL	3.394

IP190	
IA	22.51.18
R	143.469
TL	29.000
CL	57.229
SL	2.902

IP191	
IA	37.39.31
R	36.775
TL	33.000
CL	63.607
SL	5.472

0.00 0.00 0.00 0.00

M463
M462
M461
M460

E-135300.000
N-2490000.000